



# Kalia

ONCE UPON A TIME...WATER®

## RUSTIK™

### BF1510

#### PB2 Pressure Balance Shower System

#### SPECIFICATIONS

#### Components included

- BF1523-XXX\*: 1/2" Pressure balance valve with diverter and decorative trim
- 103604-XXX\*: Handshower
- 103608-XXX\*: Wallbar
- 103790-XXX\*: 60" flexible metal hose
- 106192-XXX\*: Wall outlet
- 103603-XXX\*: Tub spout

*\* XXX means that the finish color must be specified.*

#### Colors (Finishes)

- Chrome: BF1510-110
- Pure Nickel PVD: BF1510-125
- Black: BF1510-165

#### Certifications

*The specified model meets or exceeds the following standards;*



CSA B125.1  
ASME A112.18.1

ADA

*See the following sheets for the technical features of each component.*

#### Installation Notes

This product must be installed following the installation instructions provided.

#### WARRANTY

Kalia Inc. guarantees all aspects of its products to be free of defects in material and workmanship for normal residential use. **Refer to the warranty included with the Kalia products for details.**



# Kalia

ONCE UPON A TIME...WATER®

1355, 2<sup>nd</sup> Street, Industrial Park  
Sainte-Marie (Québec)  
Canada G6E 1G9

T 418-387-9090  
1-877-GO-KALIA (1-877-465-2542)  
F 418 387-9089

**KaliaStyle.com**



ONCE UPON A TIME...WATER®

**RUSTIK™**

**BF1523**

**1/2" Pressure Balance Valve With Diverter and Decorative Trim**

**SPECIFICATIONS**

**Features**

- Solid brass construction
- No visible screws
- 1/2" male inlet NPT threaded or welded
- Shut-off valves included
- Total adjustment of 19 mm (3/4")
- Support for better stability during installation included
- Can be installed back-to-back
- Push-button diverter with automatic reset

**Colors (Finishes)**

- Chrome: BF1523-110
- Pure Nickel PVD: BF1523-125
- Black: BF1523-165

**Maximum flow rate**

- 20 liters/min. (5.28 gpm) at 60 psi

**Certifications**

*The specified model meets or exceeds the following standards;*



CSA B125.1  
ASME A112.18.1



**Installation Notes**

This product must be installed following the installation instructions provided.

**WARRANTY**

Kalia Inc. guarantees all aspects of its products to be free of defects in material and workmanship for normal residential use. **Refer to the warranty included with the Kalia products for details.**

*Product dimensions:*

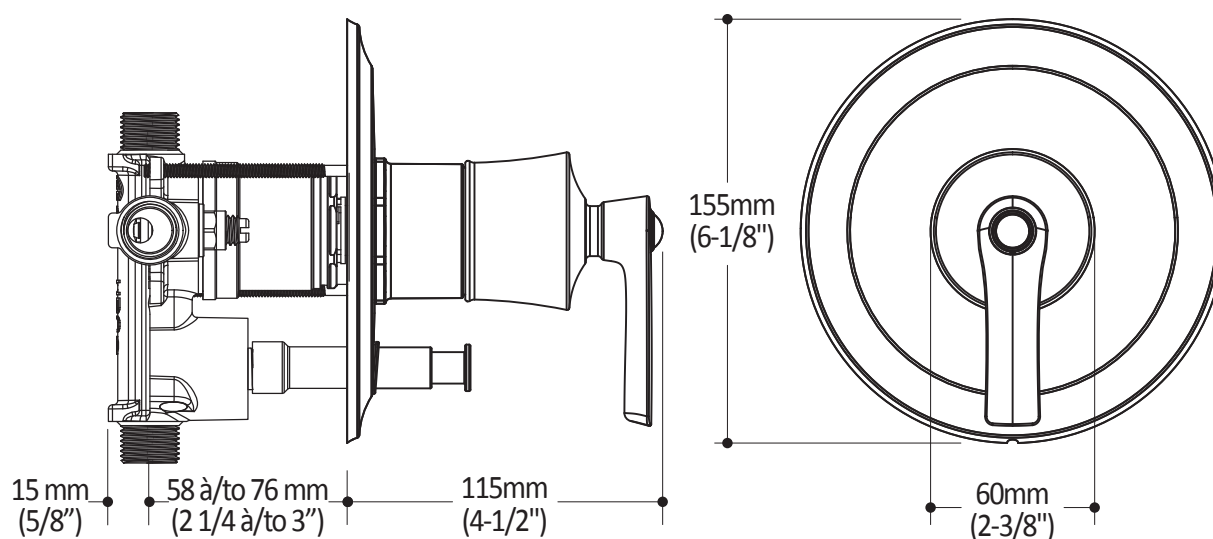

**Important:** Dimensions are approximated and are subject to changes. Please refer to the installation instructions.



ONCE UPON A TIME...WATER®

1355, 2<sup>e</sup> Rue du Parc industriel  
Sainte-Marie (Québec)  
Canada G6E 1G9

T 418-387-9090  
1-877-GO-KALIA (1-877-465-2542)  
F 418 387-9089

[kaliastyle.com](http://kaliastyle.com)



# Kalia

ONCE UPON A TIME...WATER®

## RUSTIK™

### 103604

### Handshower

### SPECIFICATIONS

#### Features

- Solid brass construction
- 83 mm (3 1/4") diameter
- Male water inlet G 1/2

#### Maximum flow rate

- 7.61 L/min (2 gpm) to 80 psi

#### Colors (Finishes)

- Chrome: 103604-110
- Pure Nickel PVD: 103604-125
- Black: 103604-165

#### Certifications

The specified model meets or exceeds the following standards;



CSA B125.1  
ASME A112.18.1

ADA



#### Installation Notes

This product must be installed following the installation instructions provided.

#### WARRANTY

Kalia Inc. guarantees all aspects of its products to be free of defects in material and workmanship for normal residential use. **Refer to the warranty included with the Kalia products for details.**

#### Product dimensions:

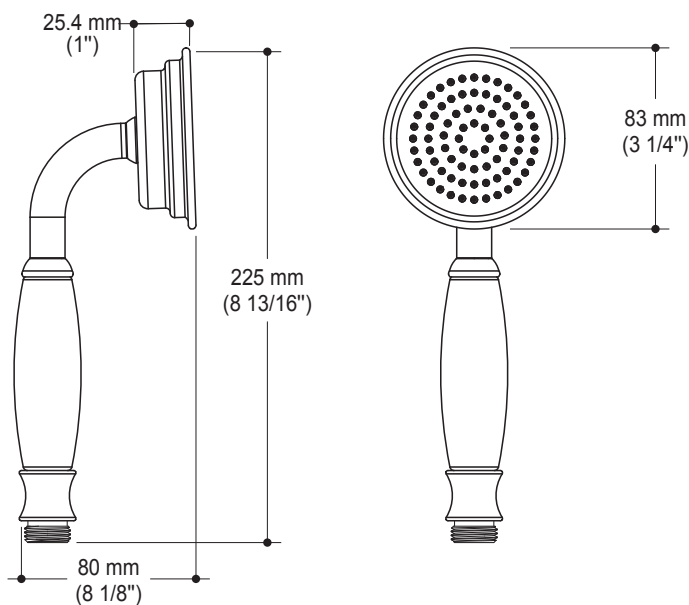

**Important:** Dimensions are approximated and are subject to changes. Please refer to the installation instructions.



# Kalia

ONCE UPON A TIME...WATER®

1355, 2<sup>e</sup> Rue du Parc industriel  
Sainte-Marie (Québec)  
Canada G6E 1G9

T 418-387-9090  
1-877-GO-KALIA (1-877-465-2542)  
F 418 387-9089

[kaliastyle.com](http://kaliastyle.com)



# Kalia

ONCE UPON A TIME...WATER®

## RUSTIK™

### 103608

### Wallbar for handshower

### SPECIFICATIONS

#### Features

- Solid brass construction
- Total height of 650 mm (25 5/8")
- Locking system of 1/4 turn

#### Colors (Finishes)

- Chrome: 103608-110
- Pure Nickel PVD: 103608-125
- Black: 103608-165

#### Certifications

*The specified model meets or exceeds the following standards;*

CSA B125.1  
ASME A112.18.1 ADA



#### Installation Notes

This product must be installed following the installation instructions provided.

#### WARRANTY

Kalia Inc. guarantees all aspects of its products to be free of defects in material and workmanship for normal residential use. **Refer to the warranty included with the Kalia products for details.**

*Product dimensions:*

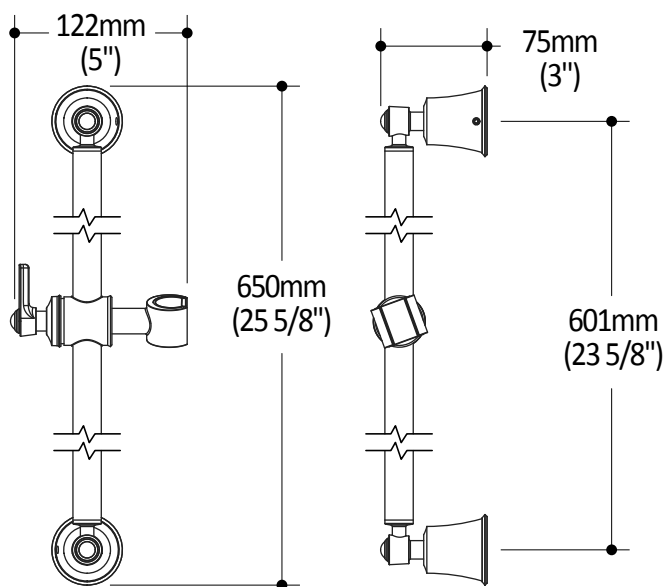

**Important:** Dimensions are approximated and are subject to changes. Please refer to the installation instructions.



# Kalia

ONCE UPON A TIME...WATER®

1355, 2<sup>e</sup> Rue du Parc industriel  
Sainte-Marie (Québec)  
Canada G6E 1G9

T 418-387-9090  
1-877-GO-KALIA (1-877-465-2542)  
F 418 387-9089

[kaliastyle.com](http://kaliastyle.com)



ONCE UPON A TIME...WATER®

**103790**

**60" (1524 mm) Flexible Metal Hose**

***SPECIFICATIONS***

**Features**

- 1/2 female connection
- Check valve included

**Colors (Finishes)**

- Chrome: 103790-110
- Pure Nickel PVD: 103790-125
- Black: 103790-165



**Installation Notes**

This product must be installed following the installation instructions provided.

**WARRANTY**

Kalia Inc. guarantees all aspects of its products to be free of defects in material and workmanship for normal residential use. **Refer to the warranty included with the Kalia products for details.**

*Product dimensions:*

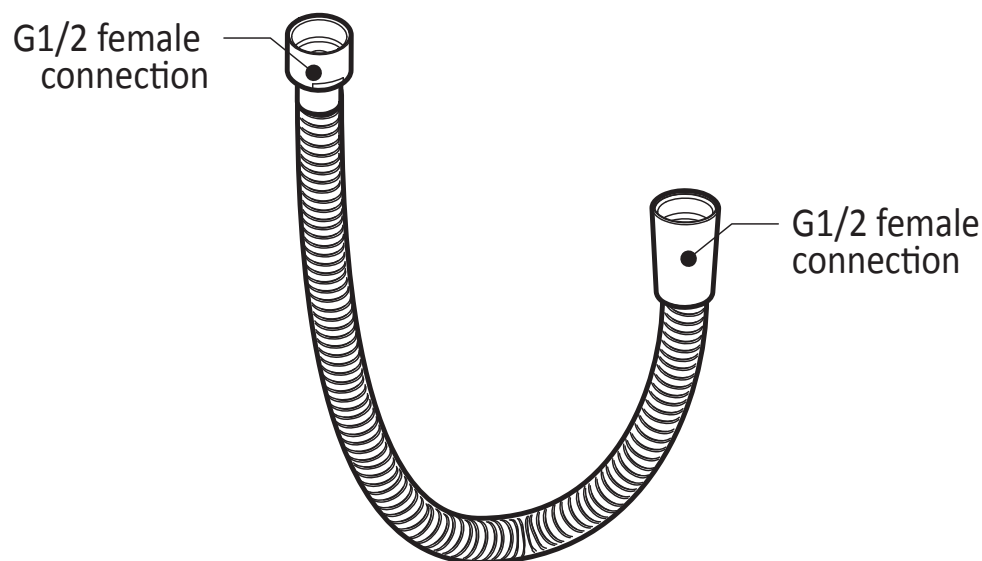

**Important :** Dimensions are approximated and are subject to changes. Please refer to the installation instructions.



ONCE UPON A TIME...WATER®

1355, 2<sup>nd</sup> Street, Industrial Park  
Sainte-Marie (Québec)  
Canada G6E 1G9

T 418-387-9090  
1-877-GO-KALIA (1-87- 465-2542)  
F 418 387-9089

**KaliaStyle.com**



ONCE UPON A TIME...WATER®

# 106192 Wall Outlet

## SPECIFICATIONS

### Features

- Solid brass construction
- Connector adjustable in depth for increased durability
- Female water inlet 1/2NPT
- Male water outlet G1/2

### Colors (Finishes)

- Chrome: 106192-110
- Pure Nickel PVD: 106192-125
- Matte Black: 106192-160
- Black: 106192-165

### Certifications

The specified model meets or exceeds the following standards;



### Installation Notes

This product must be installed following the installation instructions provided.

### WARRANTY

Kalia Inc. guarantees all aspects of its products to be free of defects in material and workmanship for normal residential use. **Refer to the warranty included with the Kalia products for details.**

Product dimensions:

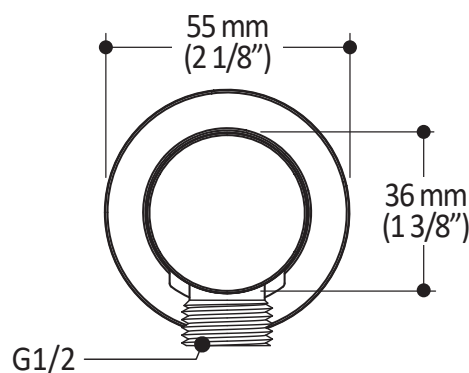
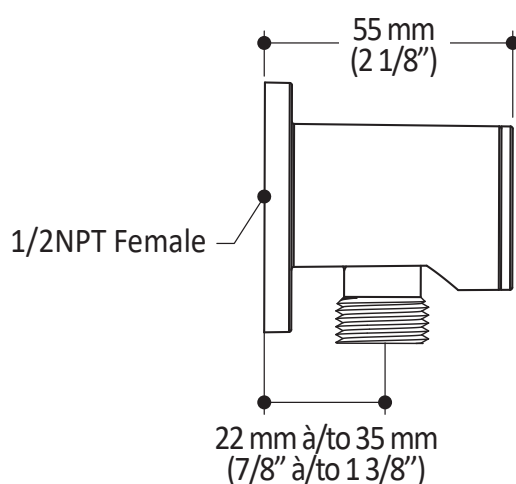

**Important:** Dimensions are approximated and are subject to changes. Please refer to the installation instructions.



ONCE UPON A TIME...WATER®

1355, 2<sup>nd</sup> Street, Industrial Park  
Sainte-Marie (Québec)  
Canada G6E 1G9

T 418-387-9090  
1-877-GO-KALIA (1-877-465-2542)  
F 418 387-9089

**KaliaStyle.com**



ONCE UPON A TIME...WATER®

**RUSTIK™**

**103603**

**Tub Spout**

**SPECIFICATIONS**

### Features

- Solid brass construction
- Hidden water jet
- High water flow
- 1/2" NPT female inlet

### Colors (Finishes)

- Chrome: 103603-110
- Pure Nickel PVD: 103603-125
- Black: 103603-165

### Certifications

*The specified model meets or exceeds the following standards;*



CSA B125.1  
ASME A112.18.1



### Installation Notes

This product must be installed following the installation instructions provided.

### WARRANTY

Kalia Inc. guarantees all aspects of its products to be free of defects in material and workmanship for normal residential use. **Refer to the warranty included with the Kalia products for details.**

*Product dimensions:*

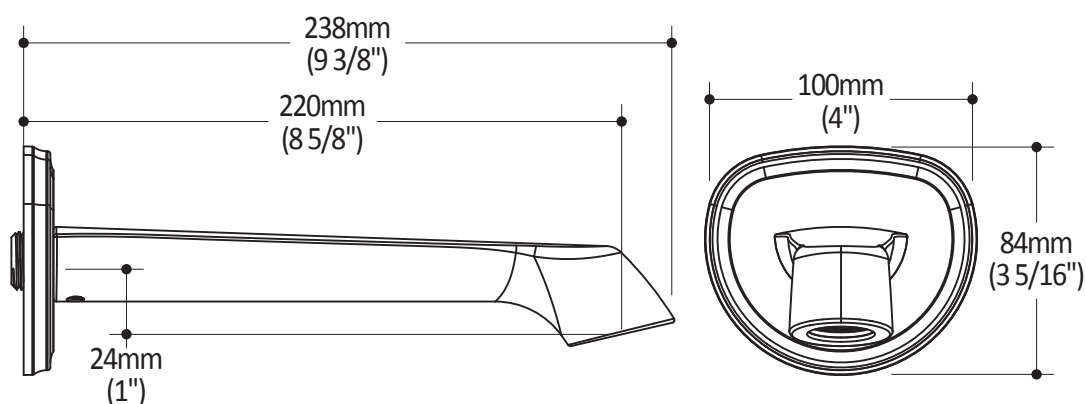

**Important:** Dimensions are approximated and are subject to changes. Please refer to the installation instructions.



ONCE UPON A TIME...WATER®

1355, 2<sup>e</sup> Rue du Parc industriel  
Sainte-Marie (Québec)  
Canada G6E 1G9

T 418-387-9090  
1-877-GO-KALIA (1-877-465-2542)  
F 418 387-9089

[kaliastyle.com](http://kaliastyle.com)